

FEMA Conceptual Design Submission

for the

Community School, serving grades 6-12

Located at the Cherry River Elementary School Site

and a

Middle and Comprehensive High School, serving grades 6-12

With an Integrated Career Technical Education Facility

Located at the Glade Creek Property

for the

Nicholas County Board of Education



August 15, 2018



Table of Contents

1. Project Narrative
2. Conceptual Project Budget
3. Cherry River Site Project Drawings
4. Glad Creek Site Project Drawings

1

Project Narrative

Community School, serving grades 6-12

Located at the Cherry River Elementary School Site

Conceptual Project Site Plan

The New Richwood Middle School and Richwood High School will be added to the existing Cherry River Elementary School. This will make the best possible use of the site and help facilitate the Community School Concept as described in the Mediation Agreement.

Conceptual Project Site Plan

The Existing Cherry River Elementary School Site is approximately 7 acres. An additional 2.74 acres will be purchased adjacent to the main entrance to the building to expand the parking and bus loop. A bus drop-off area will be added in front of the main entrance to provide a safe area for students to enter the building. A separate vehicular loop will be added around the school to provide a separate access for parent drop-off and required access per the fire code. The site consists of approximately 137 parking spaces in the front and 20 at the rear entrance of the building. There will also be parking for the custodians and cooks close to the kitchen area for early morning arrival.

Conceptual Floor Plan

The New Richwood Middle School and Richwood High School will be added to the existing Cherry River Elementary School. All of the schools will be under one roof, each of the schools will keep their own identity and have their own areas within the building. Each school will also keep their own administrative area within their specific area in the building. Each school will share a kitchen, Dining Room and mechanical system. The Dining Room will be physically divided by folding partitions for segregated the grade levels while dining. The intent is that the partitions can be folded back into the wall during larger community events, making the space more versatile and flexible for larger school programs. The total square footage for the conceptual floor plan is 108,950.

The conceptual floor plan shows the intended spaces but not limited to the spaces indicated below:

- Middle School Core Subject Classrooms
- Health Clinic
- Middle School Science Classroom/Lab
- Special Needs Life Skills Classroom
- Special Needs Classrooms
- Special Needs Resource Rooms
- Middle School Administrative Area

- Teacher Planning Area
- Conference Rooms
- Student Restrooms
- Teacher Restrooms
- Public Restrooms
- Gymnasium/Locker Rooms
- Auditorium (seating for 500)
- Biology/Physics Lab
- Science Classrooms
- High School Core Subject Classrooms
- Advanced Placement Classrooms
- Special Needs Classrooms
- Special Needs Life Skills Classroom
- Resource Classrooms
- Conference Areas
- Art Classroom
- Band Room
- High School Administrative Area
- Mechanical Room
- Electrical Room
- Sprinkler Room
- Building Support Spaces
- Storage Rooms
- Kitchen
- Dining Area
- Outdoor Amphitheater
- Outdoor Play Area
- Outdoor Learning Area

Conceptual Overall Design

The design concept is to reflect the community's heritage with wood and lumber. The intent is to create a "lodge" look with brick, natural stone and timber in the overall concept. Large timber columns will frame the new entrances with a stone and brick veneer exterior walls. Glass will be used throughout the building on the exterior walls to allow natural light for the classrooms and dining areas. Safe schools entrances will utilize the latest in design and technology to ensure a safe school for the students. Site fencing and gates will be utilized to help secure the overall site.

Middle and Comprehensive High School, serving grades 6-12

With an Integrated Career Technical Education Facility

Located at the Glade Creek Property

Conceptual Project Site Plan

The New Summersville Middle School, Comprehensive High School along with the Integrated Career Technical Education Facility will be built on the Glade Creek Property. The property will be large enough to incorporate all of the site amenities required for the Career Technical Education Facility that were previously lacking. This will allow the students to better facilitate the programs intended by the program. This will make the best possible use of the site and help facilitate the Comprehensive High School Concept as described in the Mediation Agreement.

Conceptual Project Site Plan

The proposed school site at Glade Creek is approximately 71 acres. A separate vehicular loop and Bus loop will access the school, along with the access around the building per the fire code. The site consists of approximately over 800 total parking spaces in the front and parking at the rear entrance of the building. This will provide additional event parking to the school. There will also be parking for the custodians and cooks close to the kitchen area for early morning arrival. This site will allow for support areas for the Career Technical Education programs of study. This will also allow for outside classrooms for general classroom programs throughout the building.

The Career Technical Educational Facility (CTE) will be serviced by both Richwood High School students and Nicholas County High School students. The school system will provide transportation from Richwood High school to the new CTE facility.

Conceptual Floor Plan

The Summersville Middle School, Nicholas County High School and the Integrated Career Technical Programs are all under one roof. Each of the schools will keep their own identity and have their own areas within the building. Each school will also keep their own administrative area within their specific area in the building. The proposed schools are separated by all community and athletic spaces that are shared spaces. The community will have access to the open shared spaces during off school hours. Each school will share a Kitchen, Dining Room and mechanical system. The Dining Room will be physically divided by folding partitions for segregated the grade levels while dining. The intent is that the partitions can be folded back into the wall during larger community events,

making the space more versatile and flexible for larger school programs. The total square footage for the conceptual floor plan is 344,683.

The conceptual floor plan shows the intended spaces but not limited to the spaces indicated below:

- Middle School Core Subject Classrooms
- Middle School Collaborative Learning Spaces
- Middle School Science Classroom/Lab
- Special Needs Life Skills Classroom
- Special Needs Classrooms
- Special Needs Resource Rooms
- Middle School Administrative Area
- Teacher Planning Area
- Middle School Lecture Classroom (large group)
- High School Lecture Classroom (large group)
- Conference Rooms
- Student Restrooms
- Teacher Restrooms
- Public Restrooms
- Middle School Gymnasium/Locker Rooms
- High school Gymnasium/Locker Rooms
- High School Auxiliary Gymnasium
- Wrestling Room
- Weight Training Classroom
- Exercise Classroom
- Auditorium (seating for 1,000)
- High School Biology Classroom/Lab
- High School Physics Classroom Lab
- High School General Science Classroom/Lab
- Middle School Science Classrooms/Lab
- High School Core Subject Classrooms
- High School Collaborative Learning Spaces
- Advanced Placement Classrooms
- Special Needs Classrooms
- Special Needs Life Skills Classroom
- Resource Classrooms
- Conference Areas
- Art Classroom
- Band Room
- Choir Room

- Band Choir Storage Rooms
- Individual Music Practice Rooms
- High School Administrative Area
- Mechanical Room
- Electrical Room
- Sprinkler Room
- Building Support Spaces
- Storage Rooms
- Kitchen
- Receiving area
- Storage Rooms
- Technology Distribution Rooms
- Dining Area
- Outdoor Amphitheater
- Outdoor Play Area
- Outdoor Learning Area

Career Technical Education Programs

- Forest Industry/Plant Systems Technology
- HVAC Technician Program
- Carpentry Program
- JROTC Program
- Therapeutic Services Program
- Pro-start Restaurant Management Program
- Welding Program
- Pre – Engineering Project Lead the Way Program
- Automotive Technology Program

Conceptual Overall Design

The design concept is to create a new forward thinking modern look for the school system and the surrounding area. The initial concept is to provide an energy efficient school that will save the school system utility costs for the years to come. The intent is to create a modern look with brick, stone, glass and metal panels in the overall concept. Safe schools entrances will utilize the latest in design and technology to ensure a safe school for the students. Site fencing and gates will be utilized to help secure the overall site.

2

Conceptual Project Budget

PROJECT BUDGET	
Nicholas County Board of Education New Nicholas County High School/Middle School/Career Technical Education Center	
	8/15/2018
Item	
Construction	\$103,379,730
Architect/Engineering Fees	\$5,551,166
Construction Contingency	\$5,168,987
Other Project Costs	\$11,746,203
Total	\$125,846,086

PROJECT BUDGET	
Nicholas County Board of Education New Richwood High School/Middle School at Cherry River ES	
	8/15/2018
Item	
Construction	\$23,083,060
Architect/Engineering Fees	\$2,336,910
Construction Contingency	\$1,154,153
Other Costs	\$3,425,877
Total	\$30,000,000

PROJECT BUDGET	
Nicholas County Board of Education School Construction Program	
	8/15/2018
Item	
Construction	\$126,462,790
Architect/Engineering Fees	\$7,888,076
Construction Contingency	\$6,323,140
Other Project Costs	\$15,172,080
Total	\$155,846,086

Cherry River Site Project Drawings



1

EXISTING CONDITIONS SITE PLAN

N.T.S.



1 CONCEPTUAL SITE PLAN

N.T.S.

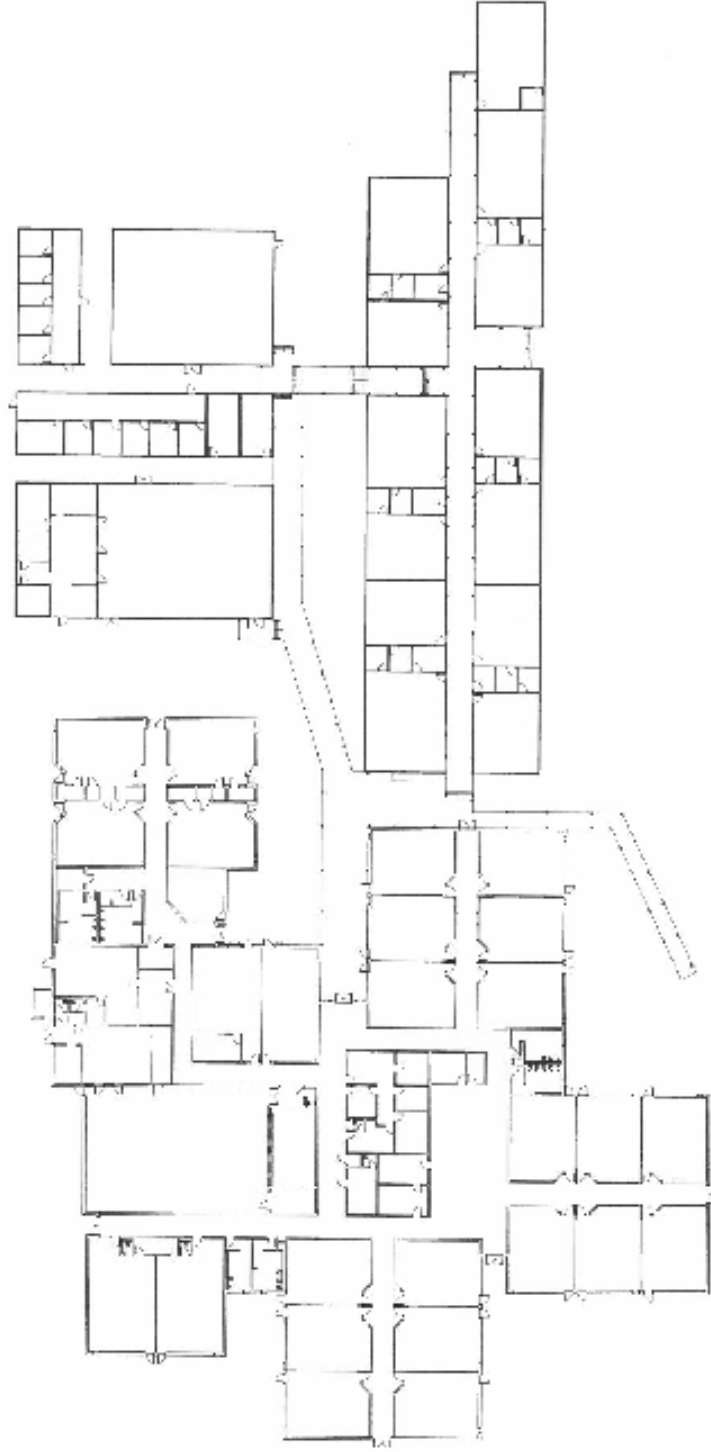

1 EXISTING CONDITIONS FLOOR PLAN

N.T.S.

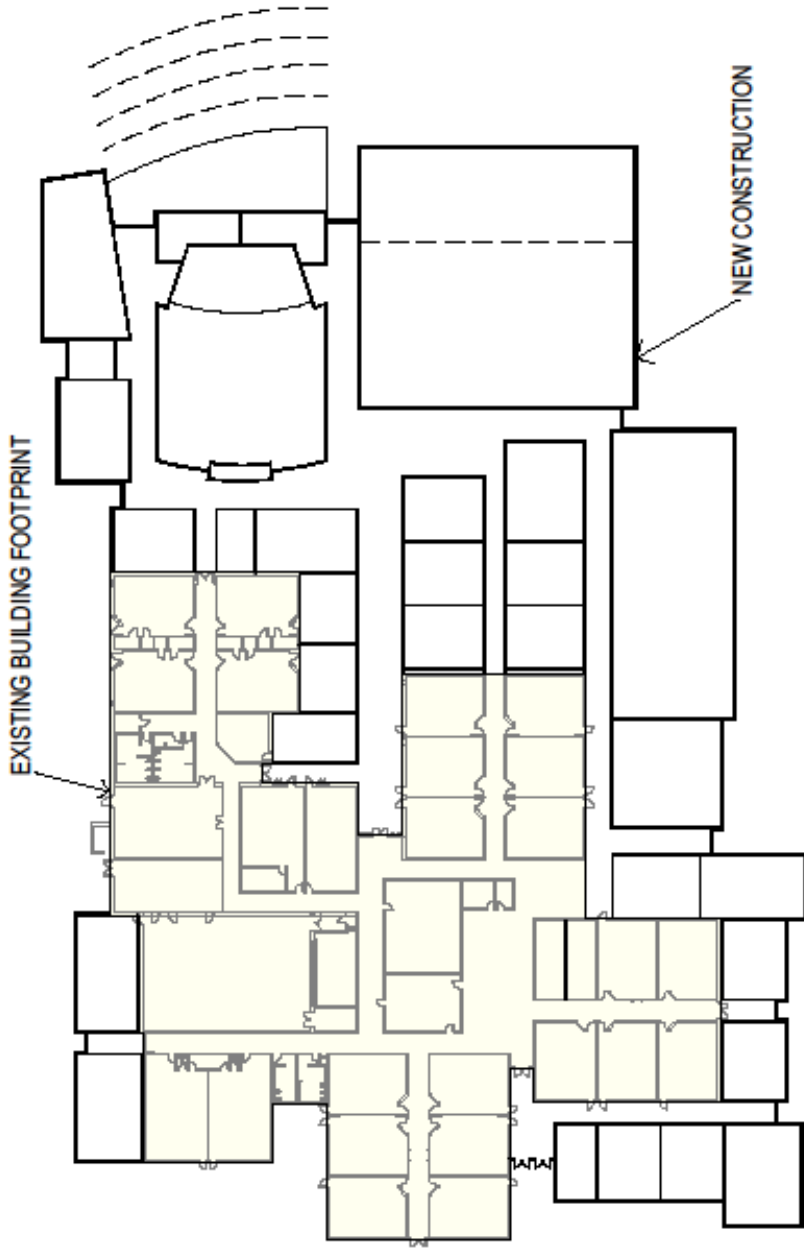

1 CONCEPTUAL UPPER LEVEL FLOOR PLAN

N.T.S.

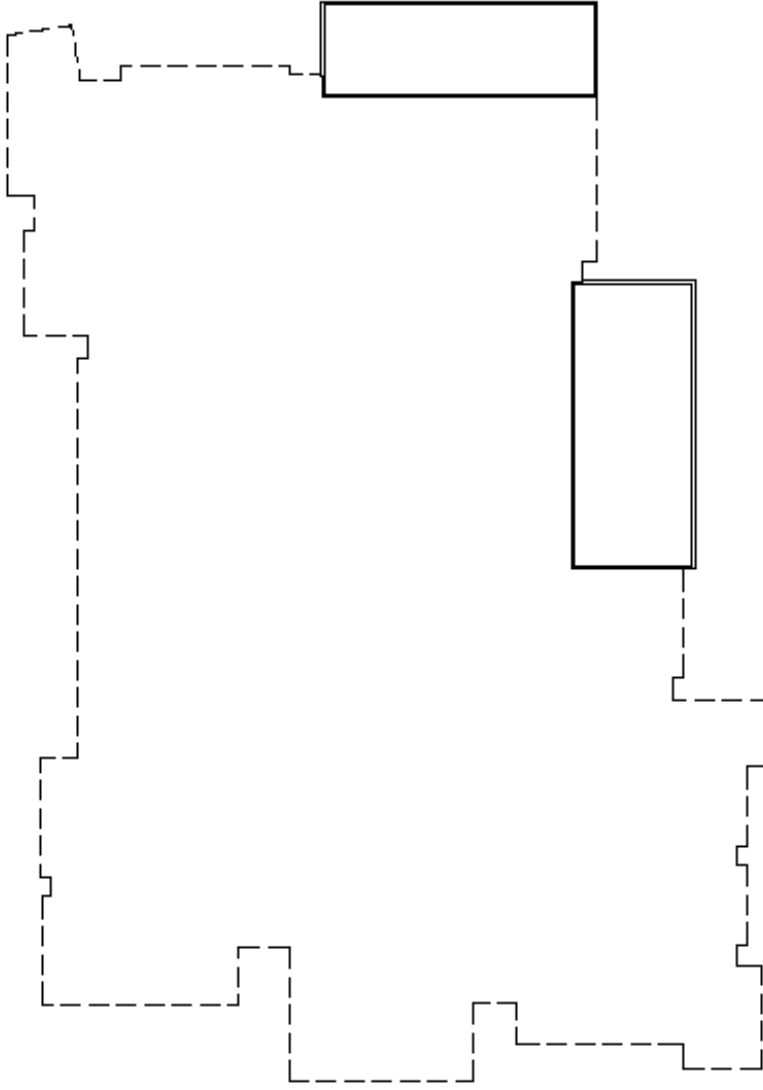

1

CONCEPTUAL LOWER LEVEL FLOOR PLAN

N.T.S.

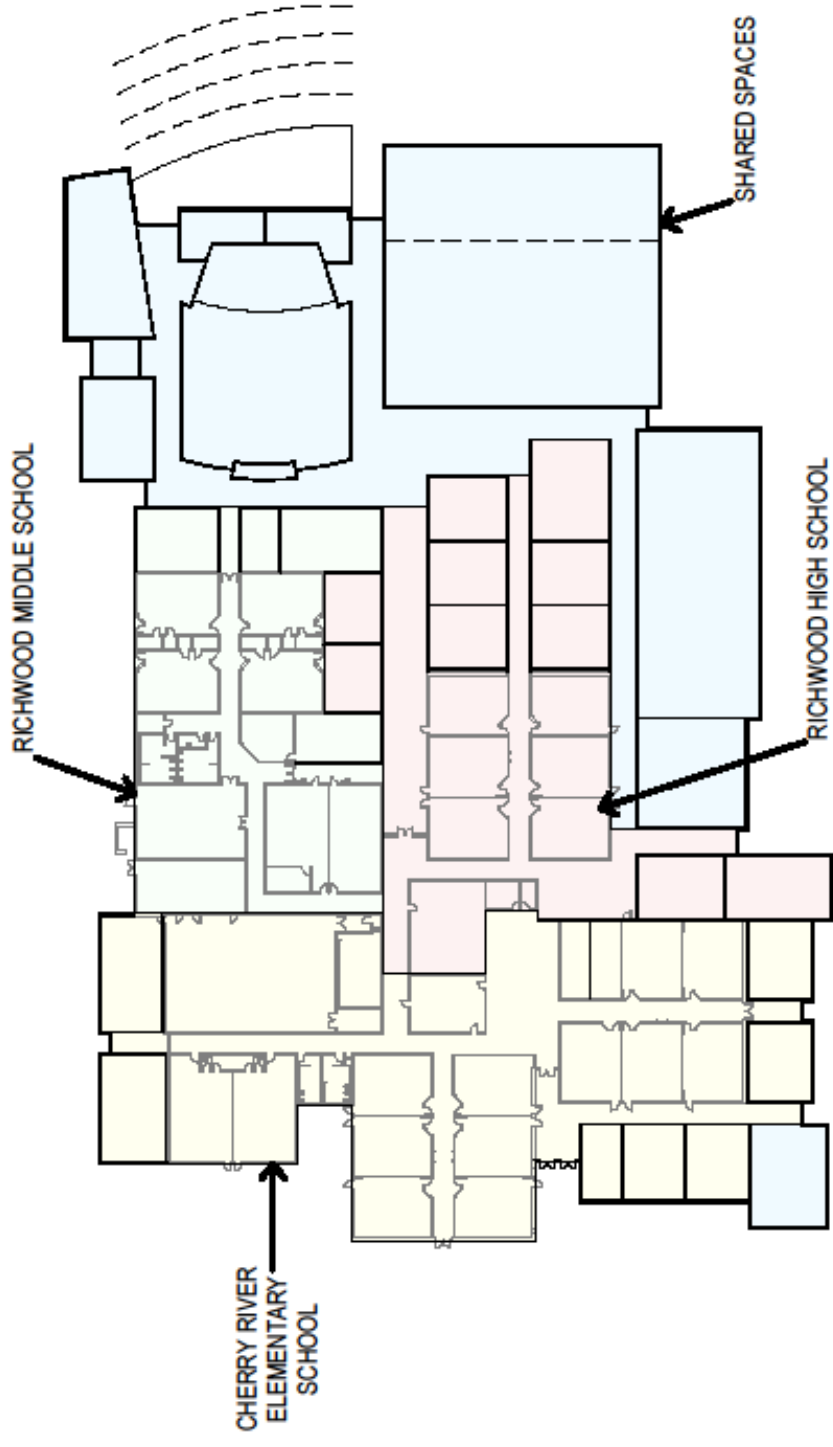

1 CONCEPTUAL AREA FLOOR PLAN

N.T.S.

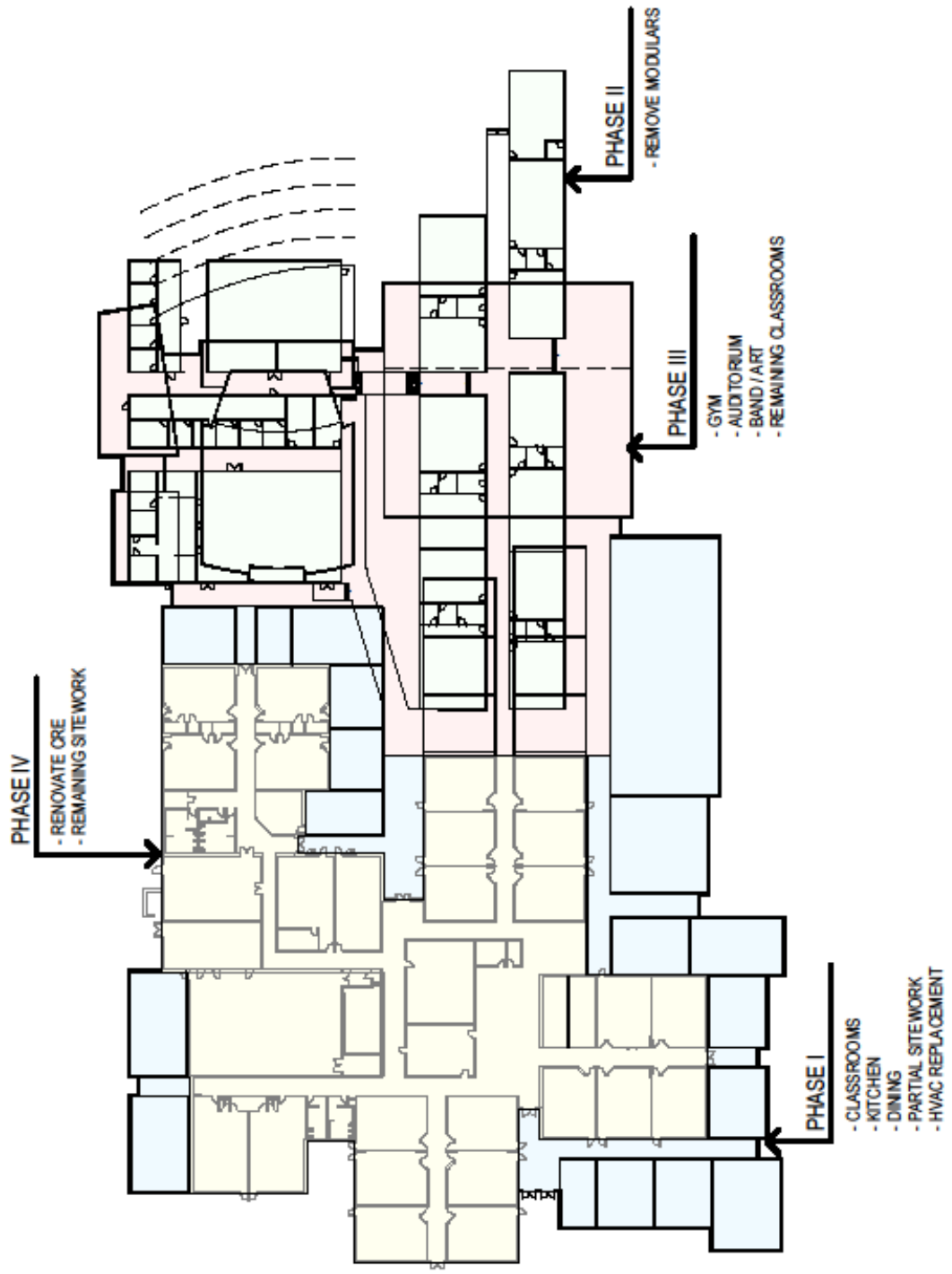

1 CONCEPTUAL CONSTRUCTION PHASING PLAN

N.T.S.

4

Glade Creek Site Project Drawings



1 EXISTING CONDITIONS SITE PLAN
N.T.S.



1 CONCEPTUAL SITE PLAN

N.T.S.

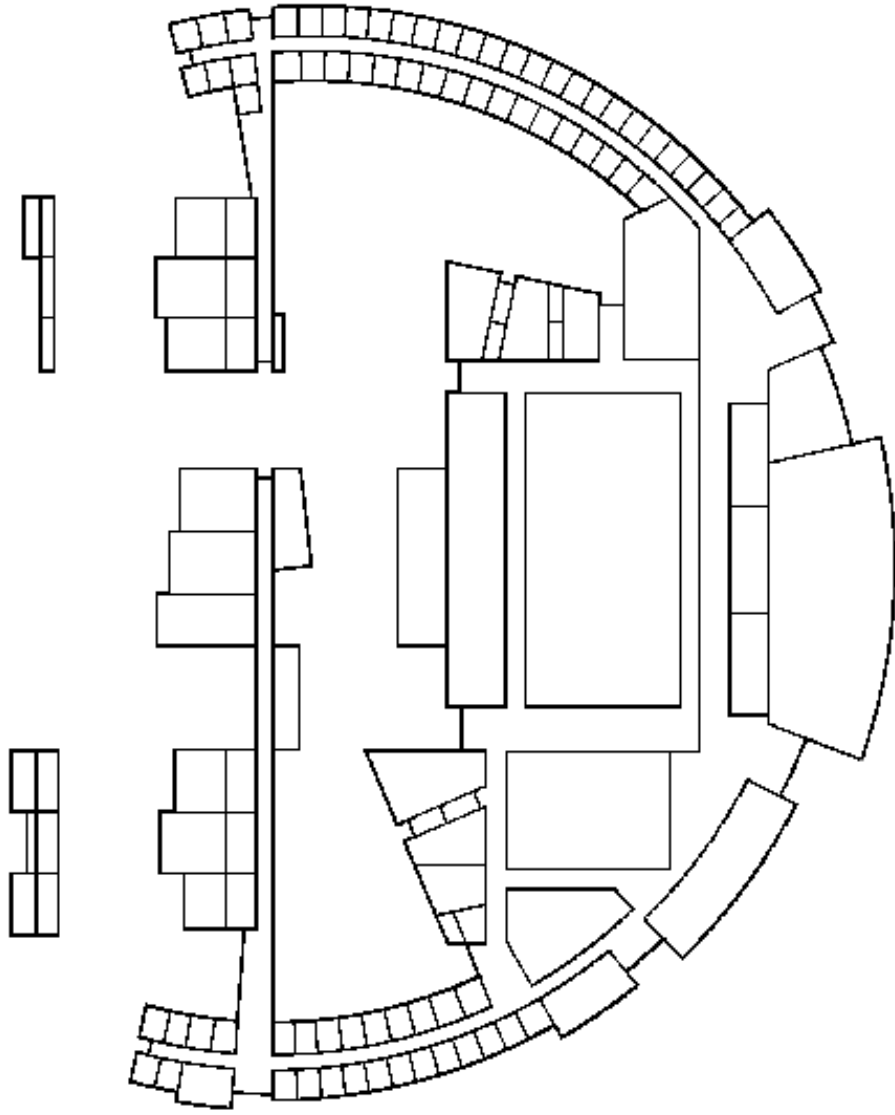

1 CONCEPTUAL LOWER LEVEL FLOOR PLAN

N.T.S.

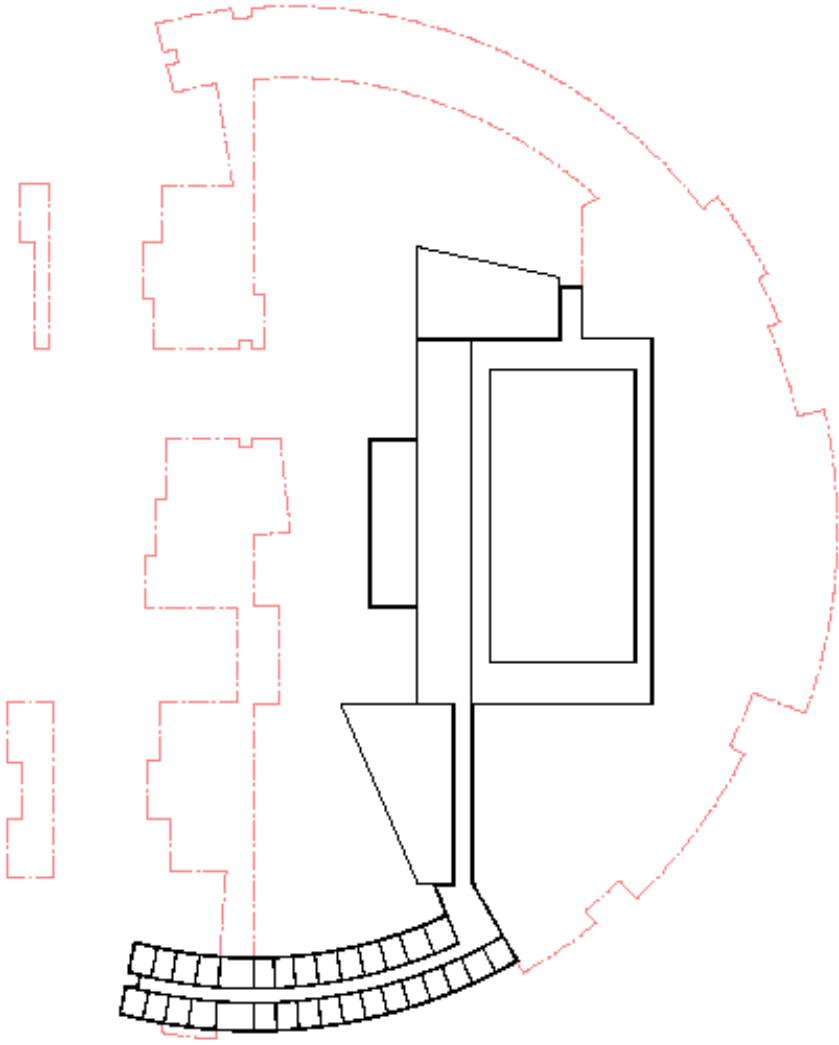

1. CONCEPTUAL UPPER LEVEL FLOOR PLAN
N.T.S.

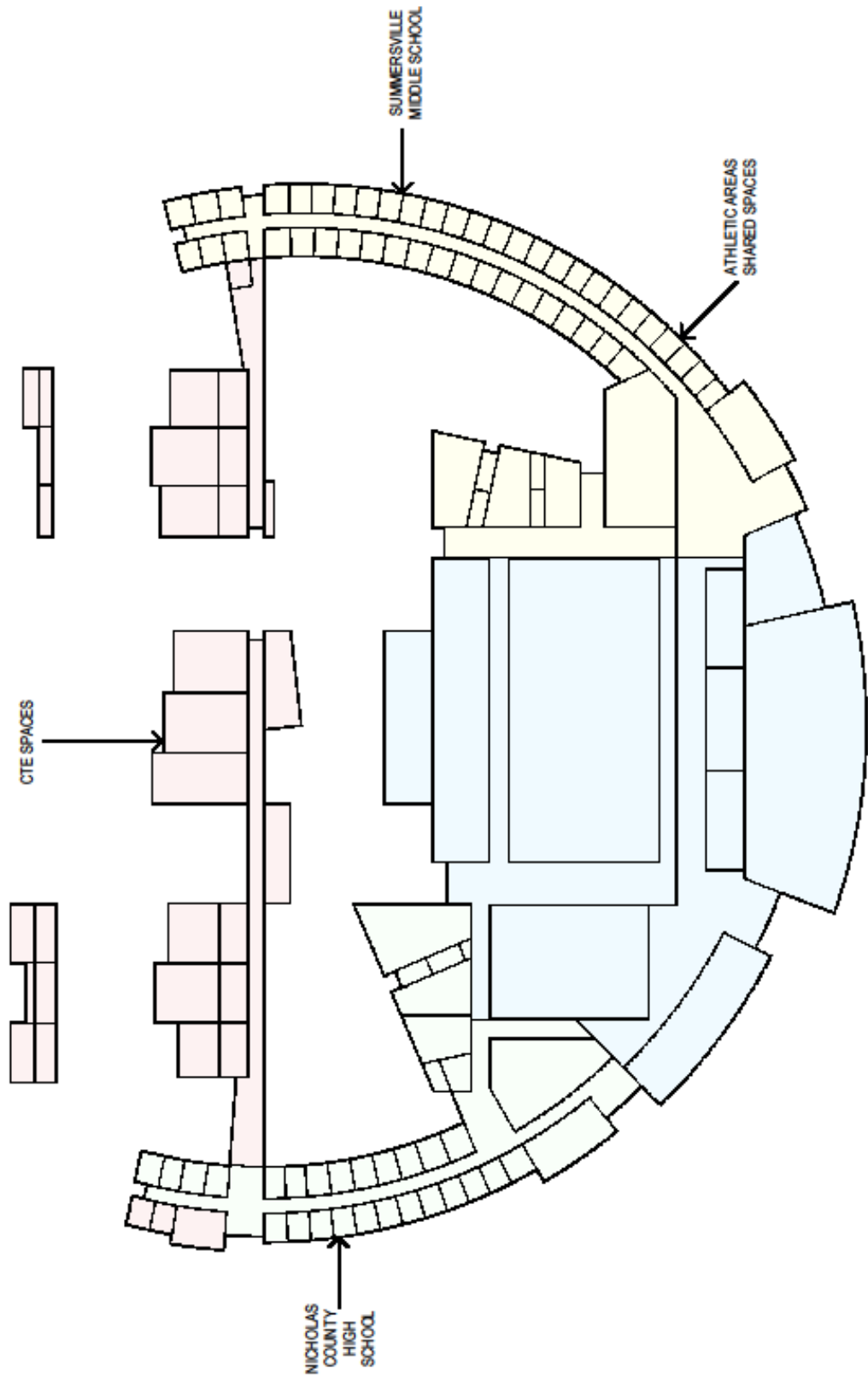

1 CONCEPTUAL AREA FLOOR PLAN

N.T.S.